

DATA SHEET

Midland Diving Equipment Ltd
 57 Sparkenhoe Street
 Leicester
 LE2 0TD
 Tel: 0116 212 4262 Fax: 0116 212 4263



NOTES:
 MAXIMUM FLOW RATE: 569 LTRS/MIN
 MAXIMUM PROCESS CAPACITY: 816 m³
 MAXIMUM WORKING PRESSURE: 414 bar
 TEST PRESSURE: 620 bar

DIMENSIONS: 478mm OAL X 120mm Diam.

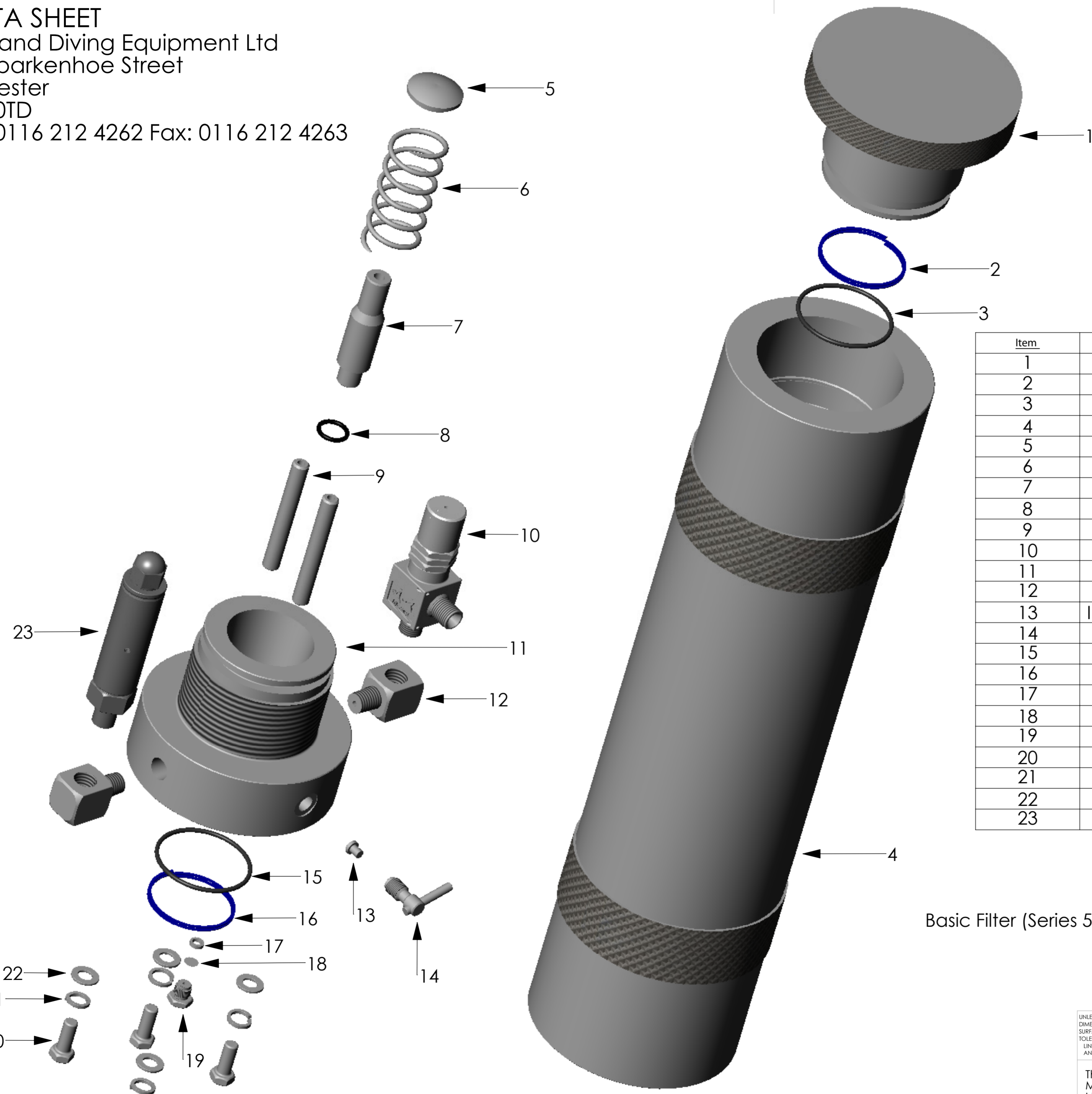

Item	Description	Part Number	QTY
1	Filter Top	M034152	1
2	Anti Extrusion Ring	M034104	2
3	O Ring	M034103	2
4	Filter Case	M034115	1
5	Spring Cap	M015707	1
6	Spring	M015706	1
7	Support Stem	M034106	1
8	Seal Washer	M034107	1
9	Inlet Tubes	M034105	2
10	PM Valve	H034770	1
11	Base	M034102	1
12	Connecting Block	M015718	2
13	Insert for Bleed Screw	M015030A	1
14	Bleed Screw	M015710	1
15	O Ring	M034103	2
16	Anti Extrusion Ring	M034104	2
17	Burst Plug Seal	G011910	1
18	Burst Disc	G011909	1
19	Burst Plug	M015711	1
20	M10 Bolt	N/A	4
21	Spring Washer	N/A	4
22	M10 Washer	N/A	4
23	Safety Valve	H013675	1

Basic Filter (Series 50L), Does not include items 10,12 and 23: H034100T

PED Certification No. CE 68404, CE 68405 & CE 523277 (Breathing Air & Group 1 Gases - Module B + D)
WARNING THIS FILTER MUST BE RETESTED EVERY 5 YEARS
MAXIMUM SERVICE LIFE: 10 YEARS SEPARATOR/FILTER UNIT - 20 YEARS AS FILTER UNIT ONLY.

<small>UNLESS OTHERWISE SPECIFIED: DIMENSIONS ARE IN MILLIMETERS SURFACE FINISH: TOLERANCES: LINEAR: ANGULAR:</small>	FINISH: Anodised	DO NOT SCALE DRAWING	REVISION
	This drawing is property of Midland Diving Equipment Ltd and is to be regarded as confidential and must not be reproduced or communicated to any other persons without our written authority.	MIDLAND DIVING EQUIPMENT LTD Issue No: 1 Date: 09/06/2008 Issued By: MH	TITLE: Filter Assy Package Series 50L
		SCALE:1:2	SHEET 1 OF 1