

ULTRA 7000

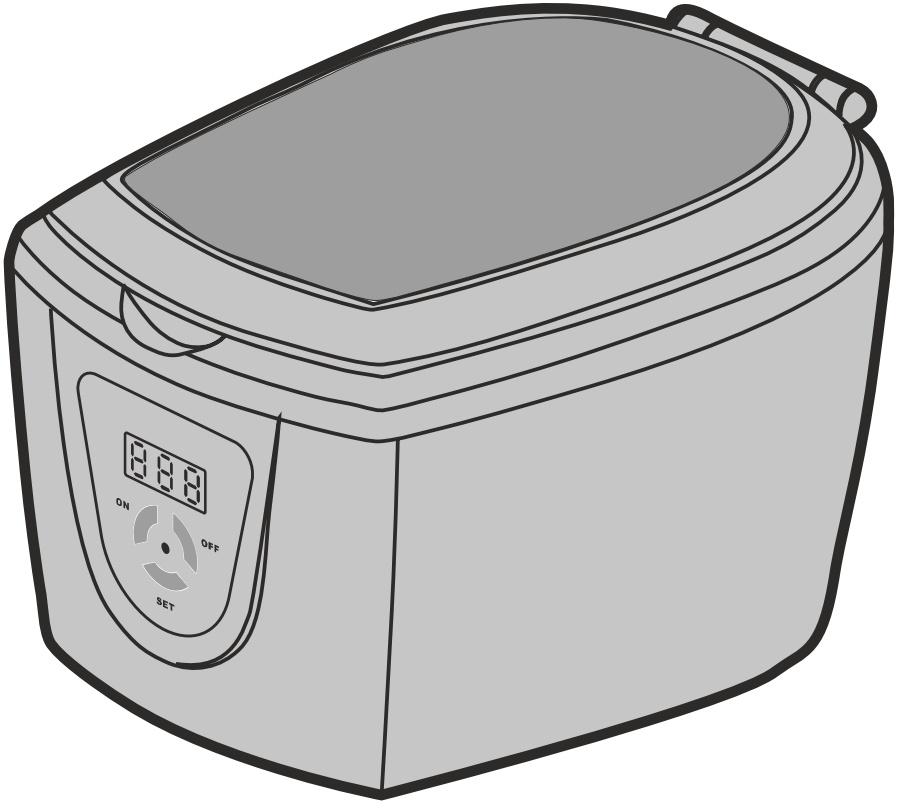

James
Products Limited

Introduction

Thank you for buying this James Products ultrasonic cleaner.

Ultrasonic cleaning is a unique phenomenon. Millions of tiny bubbles are created when ultrasonic sound is passed through liquid. It is these tiny bubbles that create incredible cleaning results.

Please read this user guide

Our Ultra range of ultrasonic cleaners are very easy to use, although to get the best from your new purchase, we recommend that you read this User Guide before cleaning. It also contains important safety information and practical hints.

Unpacking

Remove your Ultra 7000 cleaner from its packaging. Please ensure that you have the specified accessories and the correct mains plug fitted for your supply. Retain the packing carton for storage of your unit, and also in the unlikely event that the unit needs to be returned for service or repair.

Important

This unit is fitted with a 13 Amp (BS 1363) plug with a 3 Amp fuse. When replacing the fuse only a 3A ASTA approved to BS1362 type should be used. Always be sure to refit the fuse cover.

In the event that you need to change the plug then the following instructions must be followed:

- As the colours of the wires in the mains lead of this appliance may not correspond with the coloured markings identifying the terminals in your plug, proceed as follows:
 - The blue wire must be connected to the terminal marked with the letter N or coloured black.
 - The brown wire must be connected to the terminal marked with the letter L or coloured red.
 - No connection is to be made to the earth terminal of the plug.

Contents

Features and accessories	2
Important safety instructions	3
The JPL three-level clean plan	4
Choose the cleaning power you need	5
Important tips for getting better results	5
Operating instructions	6
Emptying the tank	7
Different ways of cleaning	8
Removing tarnish, carbon and rust	8
Using the accessories	9
Maintenance and storage	10
Specifications	11
Guarantee	12
Returns	12
Limited warranty	12
Our product range	13

Features and accessories

**ULTRA
7000**

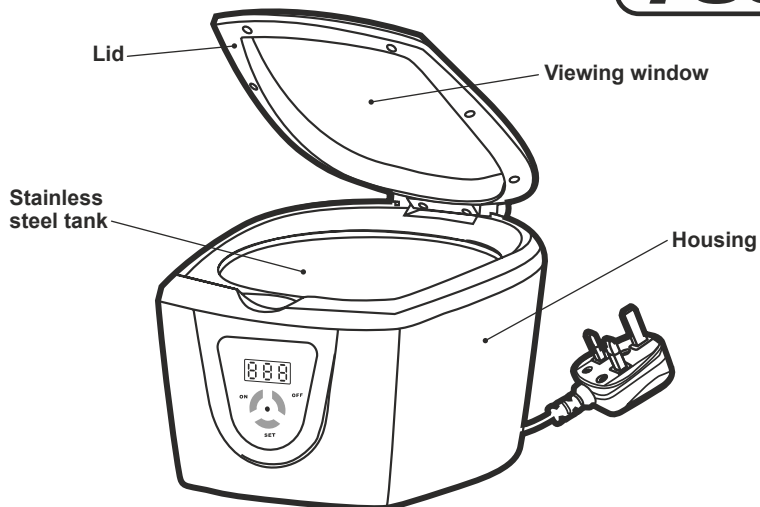

Control panel overview

On/Off buttons

These start and stop the cleaning operation

Operation indicator

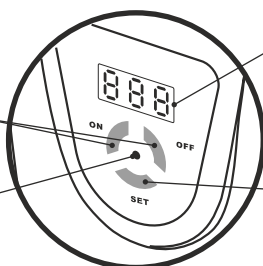

Timer display

Shows the selected cycle time and counts down during operation

Set button

Selects the cycle time

Included accessories

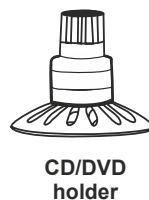
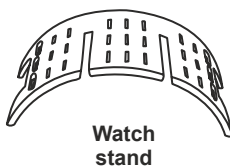
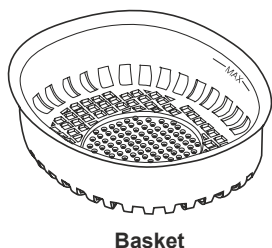

Important safety instructions

Please read this before using your product

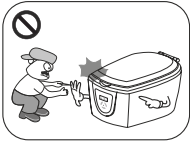

Do not attempt to remove any screws or panels.
There are no user serviceable parts inside.

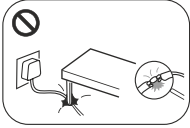

Do not operate this unit if the cord or plug is damaged.
Please refer to a service centre for examination and repair.

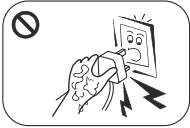

To avoid electric shock never touch the cord or socket with wet hands.

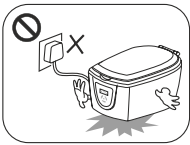

Never operate the unit when empty - damage may occur.
Keep the unit unplugged before filling.
Do not use boiling water as damage to the unit may occur.
Do not exceed the "MAX" marking on the inside of the tank.
Always unplug the unit immediately after use and before emptying the liquid.



Do not operate the unit next to heat sources such as radiators.
Operate on a dry level surface.



To avoid electric shock do not immerse the unit into water or other liquid. The unit should not be exposed to dripping or splashing and no objects filled with liquids should be placed on top of it.



Do not fill the tank with abrasives or corrosive chemicals.
Never use acids, solvents or alcohol as these are not suitable for use in this cleaner and will invalidate the warranty.
Repeated cleaning cycles will enhance the cleaning effect.



Never leave the unit unattended when the heater is switched on.
Always unplug and clean the unit when left overnight.

The JPL three-level clean plan

Lightly stained items

Use warm water and a few drops of washing up liquid

1

General staining or light tarnishing

Use warm water and Sea Clean concentrate

2

Heavily stained or tarnished metals

Use warm water with Metal Gleam concentrate

3

Use the appropriate level for your items:



Jewellery

Necklaces, rings, bracelets etc.

1 2 3



Porous stones such as pearls etc. should not be immersed. Use the optional watch stand to hold the stones out of the water. If in doubt please refer to our website: www.jpl.uk.com for further details.



Watches and glasses / sunglasses

Waterproof wristwatches, watch chains, glasses, sunglasses etc.

1 2 3



Watches should be fully waterproof (30m or more). For watches that are not waterproof, the optional Watch Stand can be used. The coating on some spectacle lenses can exhibit hairline cracking during ultrasonic cleaning. If in doubt check with your optician before cleaning such items.



Toiletry items

Electric toothbrush heads, electric shaver heads, razor blades, combs, toothbrushes, dentures etc.

Ensure that all items are waterproof and non-porous.

1 2 3

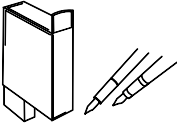

Office equipment

Printer heads, printer cartridges, fountain pen nibs, wax or rubber stamps etc.

1 2 3

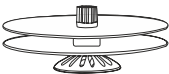

CDs, DVDs

Any CD, VCD, DVD - pre-recorded or CD-R/RW

1 2 3



Metal items (some metals need enhanced cleaning - see page 9)

Metal cutlery (knives/forks, etc.), old coins, metal badges, valves, machine nozzles, small metal parts, etc. For best results use Sea Clean or Metal Gleam concentrates as directed.

1 2 3



Any unfirm or inlaid item may become loose. Items that are easy to be discoloured are not recommended for ultrasonic cleaning. eg: textiles, leather products, woodware etc.

DO NOT put any objects that are porous (e.g. tortoiseshell or hawkbill spectacle frames) or not waterproof (e.g. mobile phones) in the tank for cleaning as damage may occur.

Choose the cleaning power you need

sea clean CONCENTRATE

- Natural active ingredients that work with your ultrasonic cleaner to remove general staining and light tarnishing from most items.
- Unique formula containing seaweed, coconut oils and other natural fruit extracts.
- Fully biodegradable.
- Available in 250ml, 500ml plus 1, 5 and 25 litre bottles.

metal gleam CONCENTRATE

- Advanced formula to deliver intensive ultrasonic cleaning results.
- Ideally suited for use with heavily stained or tarnished metals.
- Requires disposal at your local recycling centre.
- Available in 250ml, 500ml plus 1, 5 and 25 litre bottles.

Important tips for getting better results

- To start, fill the tank with warm tap water (ideally 45 to 50 degrees C). Never boiling, but bearable to put your hand into. You will always get better cleaning results with warm fluid and it will help the unit to achieve maximum cleaning potential more quickly.
- Some items need added detergent for cleaning. We recommend 3 to 4 drops of regular washing up liquid when cleaning objects such as spectacles, toiletry items, office items, etc.
- Do not overload or stack items. Remember whatever the water touches, it will clean.
- When cleaning spectacles, ensure that the lenses are free from any objects and are facing upwards. As mentioned opposite, the coating on some spectacle lenses can exhibit hairline cracking during ultrasonic cleaning. If in doubt, check with your optician or the manufacturer before cleaning such items.
- Some spectacles are not suitable for ultrasonic cleaning because the frames are made from porous materials. If you have any doubts, consult either the supplier of the spectacles or JPL before placing them in the ultrasonic cleaner.
- Delicate items Do not place delicate items directly on the stainless steel tank of the cleaner as the process of agitation may cause minor scratching. For such items, always place them on the supplied plastic tray before immersing in the tank. Do not place items too close together in order to prevent scratching through contact with other items. Unavoidably, the tray absorbs some of the ultrasonic energy which may slightly reduce the effectiveness of the cleaning action. To counter this you could try following the tips mentioned on page 9 for enhanced cleaning.

For more advice please refer to our website: www.jpl.uk.com

Operating instructions

How do I use the Ultra 7000 cleaner?



To avoid causing permanent damage: Never operate the unit without water in the cleaning tank. Never use boiling water.



1

Open the lid and fill the stainless steel tank with warm water (ideally 45 to 50°C). Do not exceed the “MAX” marking on the inside of the tank.



2

Place the item(s) to be cleaned into the water. If cleaning small items, then place the basket in the tank first. Ensure the item is immersed as fully as possible, ensuring the water level does not exceed the “MAX” marking.



To avoid the possibility of scratches from friction during operation, do not overlap items. Ensure items are spaced apart.

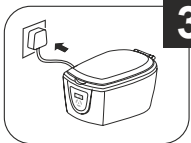

3

Close the lid and ensure your hands are dry. Plug the supplied mains cable into the unit and then into the nearest mains outlet.



4

When the unit is plugged in, the display will show the **180** second (3 minute) setting. If a different time is required, press the SET button to cycle the time through the five settings 180s - 280s - 380s - 480s - 90s. Move to the next step when the display shows your required time.



5

Press the ON button to start cleaning. The red operation indicator will illuminate while the unit is in operation. The built in timer will count down the time automatically.

Note: During operation the unit will “buzz”, this is normal.

Operating instructions (continued)

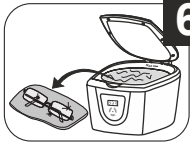

When the timer counts down to **000** the unit will automatically stop. If required, you can press the OFF button at any time to stop or pause the cleaning process. Press the ON button again to resume cleaning and continue the countdown. When cleaning has finished, you can press the ON button again to repeat the process.

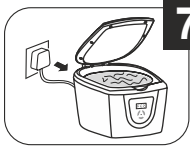

When cleaning is finished, unplug the unit from the mains and open the lid to remove the item. Pour away the water and wipe the stainless steel tank with a clean dry cloth.

Emptying the tank

- Remember to change the water between cycles as it becomes dirty.
- Always ensure the unit is unplugged when changing the water.
- Always pour liquid away via the side, avoiding the rear hinge and the control panel on the front face.
- Any waste Metal Gleam concentrate should be disposed of via the local authority solvent disposal programme.

Different ways of cleaning



To avoid causing permanent damage: Never operate the unit without water in the cleaning tank. Never use boiling water.



General cleaning

Use plain warm tap water (ideally 45 to 50°C) with a few drops of washing up liquid. Ensure that the water level does not exceed the MAX marking when immersing the item.

If the item is very dirty or has oil or grease smears (CDs, etc.) then add 3 to 4 drops of regular washing up liquid to enhance the cleaning result.



Enhanced cleaning

If the item is very dirty or has oil or grease smears then you can achieve amazing results by using either our Sea Clean or Metal Gleam concentrates (see page 5 for details).



Cleaning large items

If the item is too large to fit completely in the tank, then you can use the ultrasonic cleaner with the item partly immersed with the lid open. Ensure that the MAX marking is not exceeded when immersing the item.

Removing tarnish, carbon and rust

When removing tarnish, carbon & rust from your non-plated (e.g.: solid silver) metals, it is recommended to use a specialist cleaning solution such as Metal Gleam (see page 5 for details) when using your ultrasonic cleaner, as ultrasonic cleaning alone may not achieve the results.

If in any doubt about your items to be cleaned, before use, contact your jeweller or James Products for information and advice on cleaning your items.

Important notes

- Care should be taken when using different types of cleaning soaps or detergents. Always ensure they are suitable for the item you are cleaning. If in doubt, please ask James Products or check www.jpl.uk.com.
- If there is any danger of scratching to an item to be cleaned, place the item on the supplied plastic tray (to separate the item from the stainless steel tank) before immersing in the tank. Unavoidably, the tray absorbs some of the ultrasonic energy, which may slightly reduce the effectiveness of the cleaning action. If the item is not at risk of damage from vibrations against the stainless steel tank, then the tray can be omitted for a stronger clean.
- The use of SOLVENTS or ALCOHOL in the tank or on any part of the cleaner will damage your ultrasonic cleaner and void any warranty.

Using the accessories

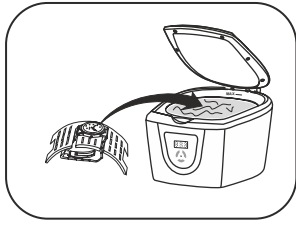

Basket

During the ultrasonic cleaning process, items tend to move in tune with the agitated fluid. Such movement may cause small scratches to occur on some delicate items if they are placed directly into the stainless steel tank. If this may be the case, place the such items in the supplied basket and then place this is into the tank.

Unavoidably, the basket absorbs some of the ultrasonic energy which may slightly reduce the effectiveness of the cleaning action. To counter this you could try using Sea Clean or Metal Gleam concentrates for enhanced cleaning.

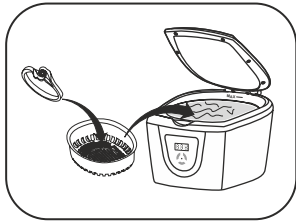

Watch stand

Only watches that are fully waterproofed to a depth of 30 metres or more should be immersed in the ultrasonic cleaner tank. If your watch is not suitable to be fully immersed, you can use the supplied watch stand to ensure that only the strap makes contact with the fluid.

Unavoidably, the watch stand absorbs some of the ultrasonic energy which may slightly reduce the effectiveness of the cleaning action. To counter this you could try using Sea Clean or Metal Gleam concentrates for enhanced cleaning.

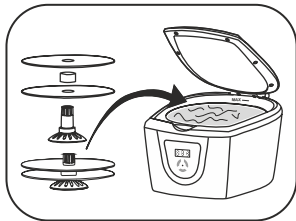

CD/DVD holder

Dirty disks are one of the main reasons why you experience problems with your player. Using a cloth or tissue to clean the disk may cause scratches.

Always use the supplied CD/DVD holder to prevent any chance of scratching. Put the disk onto the disk holder as shown (two disks can be cleaned at the same time). Fill the tank with COLD water and clean the disk for one cycle (hot water and/or continuous cleaning may affect the printing on your disk). Some CD/DVDs may have a stuck-on label which may become detached during cleaning.

Note: Ultrasonic cleaning will only remove dirt or smear marks; it cannot repair scratched or damaged disks.

Maintenance and storage

How do I keep my cleaner in perfect condition?

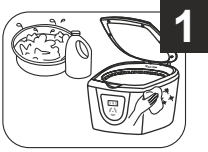

After use, ensure the unit is unplugged. Pour the water away (see note), and wipe the stainless steel tank and housing with a clean dry cloth.

To avoid electric shock, DO NOT wash the exterior of the unit with water.

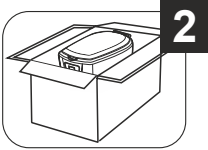

The unit should be stored in a cool dry place, away from any heat sources (radiators etc.) and sources of moisture (bathrooms etc.).

Ideally, the unit should be stored in its original packing for maximum safety.

Specifications

Model Name:	Ultra 7000
Timer Settings:	Digital with 5 time settings: 90s - 180s (default) - 280s - 380s - 480s automatic shut-off
Tank Size:	750ml stainless steel
Ultrasonic Frequency:	42,000Hz (42 kHz)
Power Consumption:	50W Max
Power Supply:	AC 220240V 50Hz
Dimensions (LxWxH):	210 x 158 x 125mm
Weight (NET):	1kg (2.2lbs)
Mains Fuse (UK only):	3A When replacing the fuse only a 3A ASTA approved to BS1362 type should be used and be sure to refit the fuse cover.

Guarantee

Your ultrasonic cleaner has been carefully manufactured and 100% tested using high quality assured components. It is guaranteed against faulty workmanship and materials for a period of twelve months from the date of purchase. In the unlikely event that a failure should occur, the unit will be repaired or replaced (at our discretion) free of charge when returned postage paid to the address below within the guarantee period. This guarantee DOES NOT include damage or failure resulting from misuse, damage in transit or failure by the user to comply with the Do's and Don'ts (this list is not exhaustive). Your statutory rights under common law are in no way affected by this guarantee.

For service in or out of the guarantee period please return the unit postage paid to:

James Products Limited
Unit 1 Church Close Business Park
Todber, Sturminster Newton
Dorset, DT10 1JH
Tel: +44 (0)1258 820100
Fax: +44 (0)1258 820550

Our opening hours are Monday to Friday 9am till 5pm.
We are closed on bank holidays.

Returns

If your ultrasonic cleaner or any accessories need to be returned, it is essential that you call us first to obtain an RMA (Return to Manufacturer Authorisation) number. You will need to provide us a description of the problem as well as your return address. If the unit is within the guarantee period please enclose proof of purchase.

In accordance with our policy of progressive product design, James Products reserve the right to change product specifications without prior notice.

Limited warranty

Consequential and incidental damages, including without limitation, loss of property and those arising from breach of any express or implied warranty, are not the responsibility of James Products Limited and to the extent permitted by law, are excluded.

Our product range

Don't miss the rest of our high quality cleaning products:

Domestic range - compact size, low power, cost-effective operation

- **Ultra 2000** *350ml tank capacity, 30W max power*
- **Ultra 6050** *750ml tank capacity, 50W max power, digital timer, adjustable power settings*
- **Ultra 7000** *750ml tank capacity, 50W max power, digital timer*
- **Ultra 7050** *750ml tank capacity, 50W max power, cordless power base, digital timer*

Semi-professional range - larger capacities and in-built water heating.

- **Ultra 8020** *2 litre tank capacity, 160W max power, heater and ultrawave function*
- **Ultra 8050** *2.5 litre tank capacity, 170W max power, heater*
- **Ultra 9000** *5 litre tank capacity, 310W max power, heater and ultrawave function*

Professional range - larger capacity, metal cased cleaners for heavy duty use (typically used with certain solvents, alcohol and acidic solutions), heating up to 85 degrees.

- **Sonic 2200** *1.5 litre tank capacity, 50W max power, push button controls*
- **Sonic 2200M** *1.5 litre tank capacity, 50W max power, rotary controls*
- **Sonic 3000** *2.3 litre tank capacity, 100W max power, push button controls*
- **Sonic 3000M** *2.3 litre tank capacity, 100W max power, rotary controls*
- **Sonic 4500** *3.6 litre tank capacity, 100W max power, push button controls*
- **Sonic 4500M** *3.6 litre tank capacity, 100W max power, rotary controls*
- **Sonic 6000** *5.4 litre tank capacity, 200W max power, push button controls*
- **Sonic 6000M** *5.4 litre tank capacity, 200W max power, rotary controls*

Sea Clean concentrate

Unique formulation, bio-degradeable additive that works with your ultrasonic cleaner to remove general staining and light tarnishing from most items.

Metal Gleam concentrate

Advanced formula to deliver intensive ultrasonic cleaning results. Ideally suited for use with heavily stained or tarnished metals.

For more information, please see our website:

www.jpl.uk.com

James

Products Limited



James Products Limited
Unit 1 Church Close Business Park
Todber, Sturminster Newton
Dorset, DT10 1JH

Tel: +44 (0)1258 820100
Fax: +44 (0)1258 820550

sales@jpltele.com

www.jpl.uk.com

Registered in England no. 5250754

Model: Ultra 7000 JPL-U7000-UG07